

Materials suitable for drinking water. Factory-backed 5 year warranty
Outside blue paint RAL 5015. Made in Europe

POLYGLASS VESSELS

- For residential & light commercial water softener/filtration applications
- Slim diameter with capacities from 8 to 185 litres
- Unmatched for strength and chemical resistance
- Threaded inlet in different sizes

COMPOSITE VESSELS

- For commercial & industrial water treatment and storage
- 100% composite fiberglass construction
- Outstanding performance and durability in harsh chemical environment
- Absolutely will not and cannot rust
- Requires little or no maintenance
- Capacities up to 1830 liters
- Flange and threaded connections available

Materials of construction

- Inner shell of polyethylene
- GRP outer shell for strength

Operating parameters

- Maximum operating pressure: 10,5 bar
- Maximum temperature: 45°C

Design parameters

- Safety factor: 4:1
- Minimum burst at 42 bars
- Tested to 250 000 cycles without leakage

Certification

- CE conformity under PED 97/23/CE
- ACS approval
- WRAs approval (Pending)



PWG TANKS

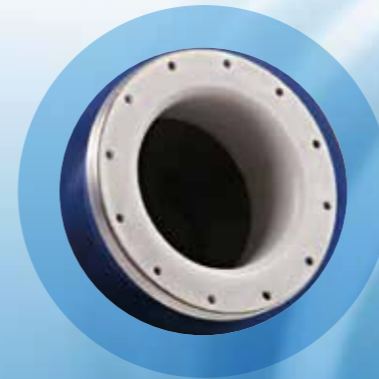

After many years of distribution, PWG analyzed the market changes and reacted on customer feedback. The customer voice defined the main criteria to be successful:

- Excellent tank quality
 - Large inventory for quick availability
 - Competitive pricing
- PWG searched for an available brand with these parameters on the market but did not succeed. We decided to discuss with the major

global suppliers based on the above defined requirements, developed its own brand and distributed it through its subsidiaries to the market. That was the birth of PWG tanks and the beginning of a long story...

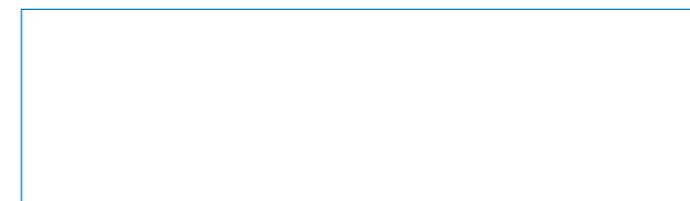

PRODUCT FEATURES

PWG DOMESTIC 2,5" THREADED VESSEL DRAWINGS

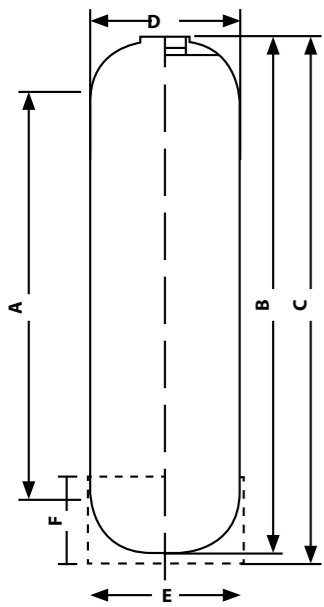

Detail 2 1/2° Thread

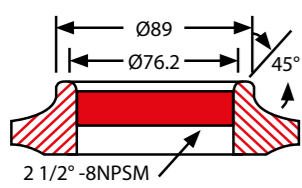

PWG INDUSTRIAL 4" THREADED VESSEL DRAWINGS

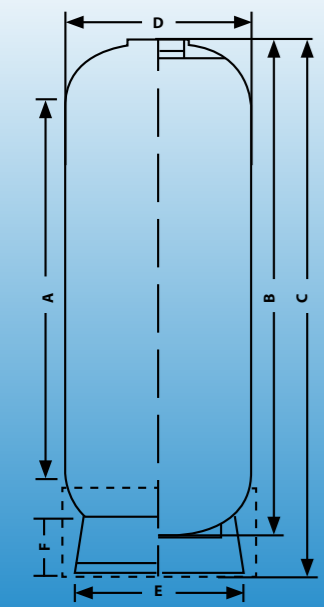

DIMENSIONS

TYPE	Item	with base / without base	Cylindrical height (mm)	Height vessel (mm) Min-max	Total height (mm) Min-max	External diameter (mm)	Outside diameter base (mm)	Height base (mm)	Volume vessel (litre)	Volume dome (litre)	Weight empty vessel (kg)	Maximum base load (kg)
			A	B	C	D	E	F	-	-	-	-
0613	0118010001	base	194	319-323	340-344	Ø159	Ø170	108	4.60	0.60	1.00	40
0618	0118010003	base	327	452-456	473-477	Ø159	Ø170	108	6.90	0.60	1.20	40
0635	0118010004	base	758	886-890	905-909	Ø159	Ø170	108	14.40	0.60	2.20	40
0713	0118010005	base		339-343		Ø184			6,30		1,40	60
0717	0118010006	base		444-448		Ø184			8,80		1,30	60
0717	0118010007	no base			444-448	Ø184			8,80		1,30	60
0730	0118010010	base	623	760-764	776-780	Ø184	Ø195	111	16.80	0.90	2.10	60
0730	0118010011	no base	623	760-764	776-780	Ø184	Ø195	111	16.80	0.90	2.10	60
0735	0118010012	base	746	883-887	899-903	Ø184	Ø195	111	20.40	0.90	2.50	60
0735	0118010013	no base	746	883-887	899-903	Ø184	Ø195	111	20.40	0.90	2.50	60
0744			969	1119-1123	1125-1129	Ø184	Ø195	111	25.30	0.90	2.30	60
0813	0118010016	base	175	328-332	345-349	Ø208	Ø220	121	8.20	1.40	1.20	75
0817	0118010017	base	263	416-420	433-437	Ø208	Ø220	121	11.00	1.40	1.50	75
0817	0118010018	no base	263	416-420	433-437	Ø208	Ø220	121	11.00	1.40	1.50	75
0818			275	428-432	445-449	Ø208	Ø220	121	11.40	1.40	1.50	75
0830	0118010019	base	612	763-767	781-785	Ø208	Ø220	121	22.00	1.40	3.10	75
0830	0118010020	no base	612	763-767	781-785	Ø208	Ø220	121	22.00	1.40	3.10	75
0835	0118010021	base	730	883-887	900-904	Ø208	Ø220	121	25.70	1.40	2.80	75
0835	0118010022	no base	730	883-887	900-904	Ø208	Ø220	121	25.70	1.40	2.80	75
0840	0118010023	base	845	1010-1014	1016-1020	Ø210	Ø220	121	29.90	1.40	3.20	75
0844	0118010024	base	951	1116-1120	1122-1126	Ø210	Ø220	121	33.60	1.40	3.40	75
0919			303	472-476	488-492	Ø233	Ø247	125	16.00	1.90	2.10	75
0935	0118010027	base	721	883-887	901-905	Ø233	Ø247	125	31.30	1.90	3.50	75
0935	0118010028	no base	721	883-887	901-905	Ø233	Ø247	125	31.30	1.90	3.50	75
1012				334-338		Ø257			11,50		2,10	140
1016	0118010031	base		423-427		Ø257			16,10		2,50	140
1016	0118010032	no base		423-427		Ø257			16,10		2,50	140
1019	0118010033	base		500-504		Ø257			19,10		2,00	140
1023				601-605		Ø257			24,00		2,60	140
1035	0118010035	base	701	883-887	901-905	Ø257	Ø269	148	38.90	2.70	4.20	140
1035	0118010036	no base	701	883-887	901-905	Ø257	Ø269	148	38.90	2.70	4.20	140
1044	0118010038	base	917	1113-1117	1120-1124	Ø257	Ø269	148	48.00	2.70	4.90	140
1054	0118010041	base	1180	1376-1380	1383-1387	Ø257	Ø269	148	60.7	2.70	6.20	140
1248	0118010043	base	992	1215-1221	1229-1235	Ø304	Ø315	180	75.6	4.40	6.60	170
1252	0118010044	base	1097	1315-1321	1332-1338	Ø304	Ø315	180	84.0	4.40	7.80	170
1354	0118010048	base	1117	1348-1354	1368-1374	Ø334	Ø341	190	103.1	5.90	9.20	225

DIMENSIONS

TYPE	Item	with base / without base	Cylindrical height (mm)	Height vessel (mm) Min-max	Total height (mm) Min-max	External diameter (mm)	Outside diameter base (mm)	Height base (mm)	Volume vessel (litre)	Volume dome (litre)	Weight empty vessel (kg)	Maximum base load (kg)
			A	B	C	D	E	F	-	-	-	-
1452-3	0118020002		1076	1332	1350-1380	Ø369	Ø330	80	122	7,30	15,50	320
1465-3	0118020003		1366	1622	1630-1660	Ø369	Ø380	200	140	7,30	19,00	320
1665-3	0118020006		1362	1620	1630-1660	Ø406	Ø420	215	170	10,10	20,50	410
1865-3	0118020008		1350	1652	1720-1750	Ø469	Ø510	170	252	15,10	32,00	685
2160-3	0118020010		1151	1509	1610-1640	Ø552	Ø510	170	309	24,00	32,00	685
2469-3	0118020012		1328	1748	1850-1890	Ø610	Ø510	170	440	35,00	41,00	985

Detail 4" Thread

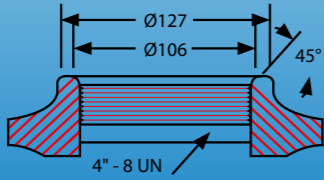

PWG INDUSTRIAL 4" FLANGE TOP BOTTOM VESSEL DRAWINGS

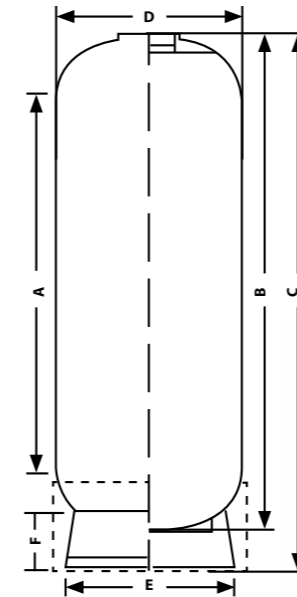

DIMENSIONS

TYPE	Item	with base / without base	Cylindrical height (mm)	Height vessel (mm) Min-max	Total height (mm) Min-max	External diameter (mm)	Outside diameter base (mm)	Height base (mm)	Volume vessel (litre)	Volume dome (litre)	Weight empty vessel (kg)	Maximum base load (kg)
			A	B	C	D	E	F	-	-	-	-
1465-7	0118020004		1376	1650	1800-1830	Ø369	Ø374	335	140	7,30	21,60	325
1665-7	0118020007		1371	1647	1790-1830	Ø406	Ø410	362	170	10,10	24,00	420
1865-7	0118020009		1350	1676	1856-1886	Ø469	Ø539	309	245	15,10	33,00	690
2160-7	0118020011		1155	1545	1755-1785	Ø552	Ø539	309	310	24,00	35,00	690
2469-7	0118020013		1327	1780	1995-2025	Ø610	Ø539	309	435	35,00	43,00	990
3072-7	0118020014		1313	1834	2010-2050	Ø770	Ø768	334	712	67,00	84,00	1590
3672-7	0118020015		1266	1897	2110-2150	Ø927	Ø768	334	1084	116,00	99,00	2240

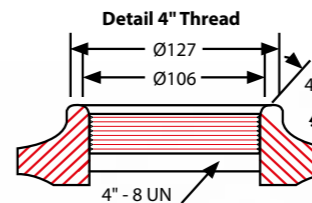

PWG INDUSTRIAL 6" FLANGE TOP BOTTOM VESSEL DRAWINGS

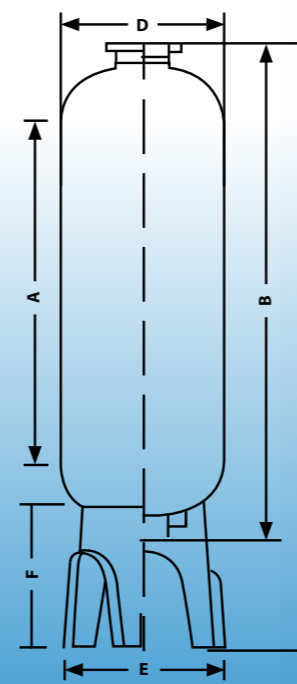

DIMENSIONS

TYPE	Item	with base / without base	Cylindrical height (mm)	Height vessel (mm) Min-max	Total height (mm) Min-max	External diameter (mm)	Outside diameter base (mm)	Height base (mm)	Volume vessel (litre)	Volume dome (litre)	Weight empty vessel (kg)
			A	B	C	D	E	F	-	-	-
3078-7			1284	1924	2260-2300	Ø770	Ø816	515	712	67	85
3678-7			1272	1975	2310-2350	Ø927	Ø1001	555	1020	116	101
4278-7			1162	1980	2395-2435	Ø1074	Ø1152	593	1345	176	133
4882-7			1075	2033	2410-2450	Ø1226	Ø1303	605	1830	273	178
55140-7			2000	3016	3541-3581	Ø1429	Ø1370	727	3984	466	401

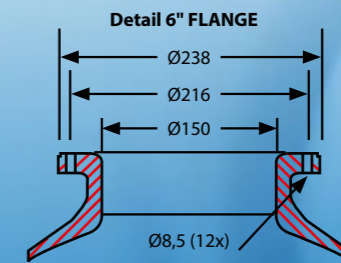
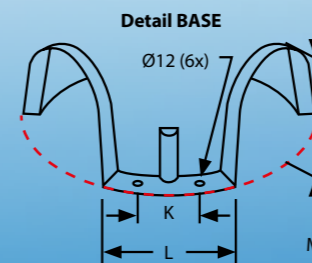

Maximum base load (kg)	Boit distance base (mm)	Width base leg (mm)	Free height base (mm)
-	-	-	-
1590	110	240	330
2245	110	265	380
2990	108	278	412
4040	150	316	414
13600	300	633	476